

### Product Description

BondorPanel<sup>®</sup> EPS-FR is a versatile and high performing insulated wall and ceiling panel used in controlled environments such as cold storage, food preparation areas and clean rooms but extends its use to transportable offices, wall partitions and many other applications. BondorPanel<sup>®</sup> has an exterior and interior lining made from COLORBOND<sup>®</sup> steel and is available in Permagard<sup>®</sup> White which contains Microban<sup>®</sup> anti-bacterial protection. BondorPanel<sup>®</sup> is available in a range of other standard COLORBOND<sup>®</sup> colours and surface profiles offering a variety of design options.



**Colorbond<sup>®</sup>**  
Permagard<sup>®</sup>

Panel Properties							
Panel Thickness (mm)	50	75	100	125	150	200	250
Mass (kg/m <sup>2</sup> )	11.30	11.60	12.00	12.30	12.70	13.30	14.00
Thermal Performance at 6°C							
'U' Value (W/m <sup>2</sup> K)	0.76	0.51	0.38	0.30	0.25	0.19	0.15
'R' Value (m <sup>2</sup> K/W)	1.32	1.92	2.63	3.29	3.95	5.26	6.58

### Span Table

#### NON-CYCLONIC REGION A&B (WALL APPLICATIONS ONLY)

SL Grade EPS-FR Core / 0.6mm Steel Skins.

Maximum uniformly distributed ultimate wind load (kPa) for the given span:

Single Span, wind pressure acting inwards/outwards							
Span (mm)	Panel Thickness (mm)						
	50	75	100	125	150	200	250
1500	3.39	5.09	6.79	8.48	10.18	13.58	16.97
2700	1.86	2.83	3.77	4.71	5.66	7.54	9.43
3900	0.95	1.57	2.09	2.62	3.14	4.19	5.24
5100	0.54	0.92	1.22	1.53	1.84	2.45	3.06
6300	0.33	0.60	0.80	1.00	1.20	1.60	2.01
7500	-	0.42	0.57	0.71	0.85	1.13	1.42
8700	-	0.30	0.42	0.53	0.63	0.84	1.05

Multi-span, wind pressure acting inwards/outwards							
Span (mm)	Panel Thickness (mm)						
	50	75	100	125	150	200	250
1500	2.72	4.07	5.43	6.79	8.15	9.92	9.92
2700	1.51	2.26	3.02	3.77	4.53	5.51	5.51
3900	1.04	1.57	2.09	2.61	3.13	3.82	3.82
5100	0.61	0.92	1.22	1.53	1.84	2.45	2.92
6300	0.40	0.60	0.80	1.00	1.20	1.60	2.01
7500	0.28	0.42	0.57	0.71	0.85	1.13	1.42
8700	-	0.32	0.42	0.53	0.63	0.84	1.05

\*Refer notes 1-4.

### Span Table INTERNAL COLD STORAGE

SL Grade EPS-FR Core / 0.6mm Steel Skins. Maximum span (mm):

Single Span, internal cold storage 0°C or more							
Application	Panel Thickness (mm)						
	50	75	100	125	150	200	250
Walls (Non-Load Bearing)	-	5700	7100	8300	9300	10800	12000
Walls (Load Bearing)	-	5100	6500	7500	8200	9500	10700
Ceilings	-	5100	6300	7200	7800	9000	9900

Multi-span, internal cold storage 0°C or more							
Application	Panel Thickness (mm)						
	50	75	100	125	150	200	250
Walls (Non-Load Bearing)	-	6500	7500	8900	9100	10500	11700
Walls (Load Bearing)	-	6000	6900	7700	8400	9700	10900
Ceilings	-	5300	6000	6900	7500	8600	9600

\*Refer notes 3-10.

Core	EPS-FR (Expanded Polystyrene with fire retardant)
Width (cover mm)	1200
Thickness (mm)	50, 75, 100, 125, 150, 200, 250
Length	Up to 16m (check for availability)
Exterior Facing Skin	0.6mm G300 CRP grade COLORBOND <sup>®</sup> steel
Interior Facing Skin	0.6mm G300 CRP grade COLORBOND <sup>®</sup> steel
Exterior Facing Colour	Permagard <sup>®</sup> White or other standard & non-standard colours
Standard Colours	
Interior Facing Colour	Permagard <sup>®</sup> White
Finishes	Plain, Ribbed, Satinline
Acoustic Properties	R <sub>w</sub> 24
Fire Hazard Properties - AS1530.3 indices	
Ignitability Index	0
Spread of Flame Index	0
Heat Evolved Index	0
Smoke Index	2-3

#### AS/ISO 9705 - BCA Group Number (Spec C1.10a)

BondorPanel<sup>®</sup> EPS-FR steel skinned insulated building panels conform to the requirements of the BCA Specification C1.10a as either Group 2 or Group 1 depending on the thickness and construction detail.

##### Group 1

Panel up to 250mm thick with steel 'wall-wall' and 'wall-ceiling' angles fixed with steel rivets or screws at 1200mm centres is classified as Group 1.

##### Group 2

Panel 150mm or less with an aluminium 'wall-wall' and 'wall-ceiling' angles fixed with aluminium rivets or screws at 300mm centres is classified as Group 2. Panel thicker than 150mm requires steel 'wall-wall' and 'wall-ceiling' angles fixed with steel rivets or screws at 300mm centres to be classified as Group 2.

#### NOTES:

- Extended span tables including cyclonic regions C&D and 300mm thick panel are also available. Refer Bondor<sup>®</sup>.
- Fixing with min. 14g tek screws (x4 off) or mushroom head bolts (x2 off) per fixing point are required.
- Pressures specified are for wind gusts only per AS 1170.
- Deflection limit of span/150 applies, and in accordance with Serviceability Limit State criteria per AS1170.0 - TABLE C1.
- This span table applies for cold storage constructed wholly within a larger enclosed building. Pressure relief port is to be provided for a freezer in accordance with Bondor<sup>®</sup> recommendation.
- Panel thicknesses of not less than 100mm are recommended for chillers, not less than 150mm for freezers and not less than 200mm for blast freezers, depending on structural considerations. Check 'R' value for insulation requirements.
- Fixing with min. 14g tek screws (x4 off) per fixing point or mushroom head bolts (x1 off at end support and x2 off at intermediate supports) are required.
- Self weight of the panel has been allowed for, plus an allowance of up to 10kg/m<sup>2</sup> for light duty fittings (lights, etc.). No other dead loads permitted.
- Non-trafficable maintenance access (concentrated load) of 140kg on any one panel has been allowed for (exceeding min. requirements of AS/NZS 1170.1:2002).
- Distributed live load of 0.25kPa (as per AS/NZS 1170.1:2001) has been allowed for. Bondor<sup>®</sup> tests comply with details outlined in AS 4040, AS 1562 and as 1170.

### Joint

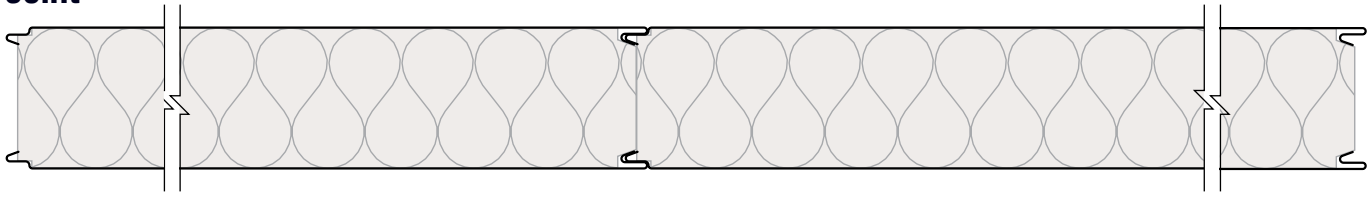

### Profiles

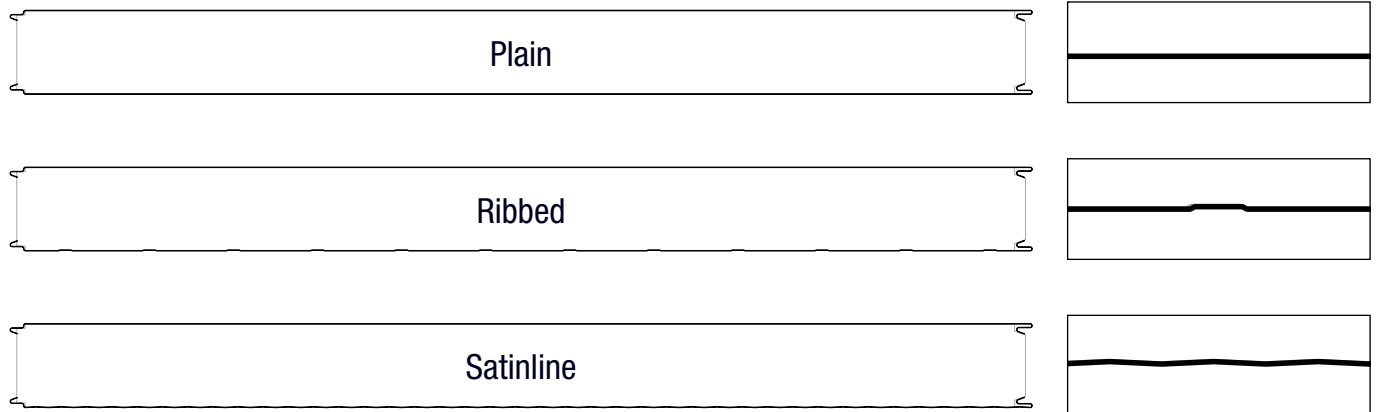

### Dimensions

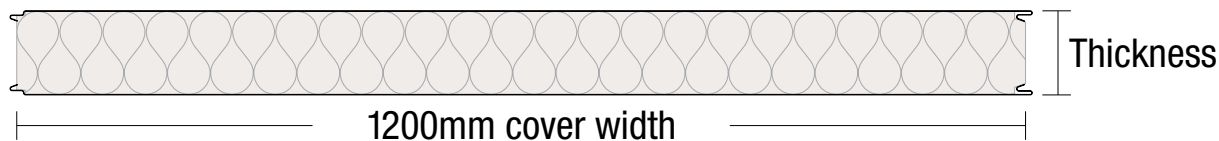

### Bondor<sup>®</sup> National Network

**BRISBANE / EXPORT**  
103 Ingram Road  
Acacia Ridge QLD 4110  
T: 07 3323 8500  
F: 07 3323 8501

**PERTH**  
17 Gauge Circuit  
Canning Vale WA 6155  
T: 08 9256 0600  
F: 08 9256 0620

**MELBOURNE**  
329A St Albans Road  
Sunshine VIC 3020  
T: 03 8326 8000  
F: 03 8326 8099

**ADELAIDE**  
70 – 72 Rundle Road  
Salisbury South SA 5106  
T: 08 8282 5000  
F: 08 8282 5099

**SYDNEY**  
49 – 53 Newton Road  
Wetherill Park NSW 2164  
T: 02 9609 0888  
F: 02 9729 1114

**LAUNCESTON**  
7 Connector Park Drive  
Kings Meadows TAS 7249  
T: 03 6335 8500  
F: 03 6335 8544

To connect to your nearest Bondor<sup>®</sup> branch simply call 1300 300 099 or visit [www.bondor.com.au](http://www.bondor.com.au)

Metecno Pty Limited. ABN 44 096 402 934. The manufacturer reserves the right to change the specification without notice. Bondor<sup>®</sup>, Equitit<sup>®</sup>, BondorPanel<sup>®</sup>, FlameGuard<sup>®</sup>, MetecnoPanel<sup>®</sup>, InsulWall<sup>®</sup>, SolarSpan<sup>®</sup>, MetecnoSpan<sup>®</sup>, Purline<sup>®</sup>, Equideck<sup>®</sup>, InsulLiving<sup>®</sup>, Metecno, MetecnoSpanTH & MetecnoPanelTH are trademarks of Metecno Pty Limited. BlueScope, COLORBOND<sup>®</sup>, Permagard<sup>®</sup> and colour names are trademarks of BlueScope Steel Limited. Microban<sup>®</sup> is a registered trade mark of the Microban Products Company. The colours shown in this publication have been reproduced to represent actual product colours as accurately as possible. However, given printing limitations, we recommend checking your chosen colour against an actual sample before placing orders. This advice is of a general nature only. Designers must provide for adequate structural performance and other Building Code requirements. This information is subject to change. Refer to Bondor<sup>®</sup> website for latest version. Consult Bondor<sup>®</sup> for your application.



Leaders in Thermal & Architectural Building Solutions