

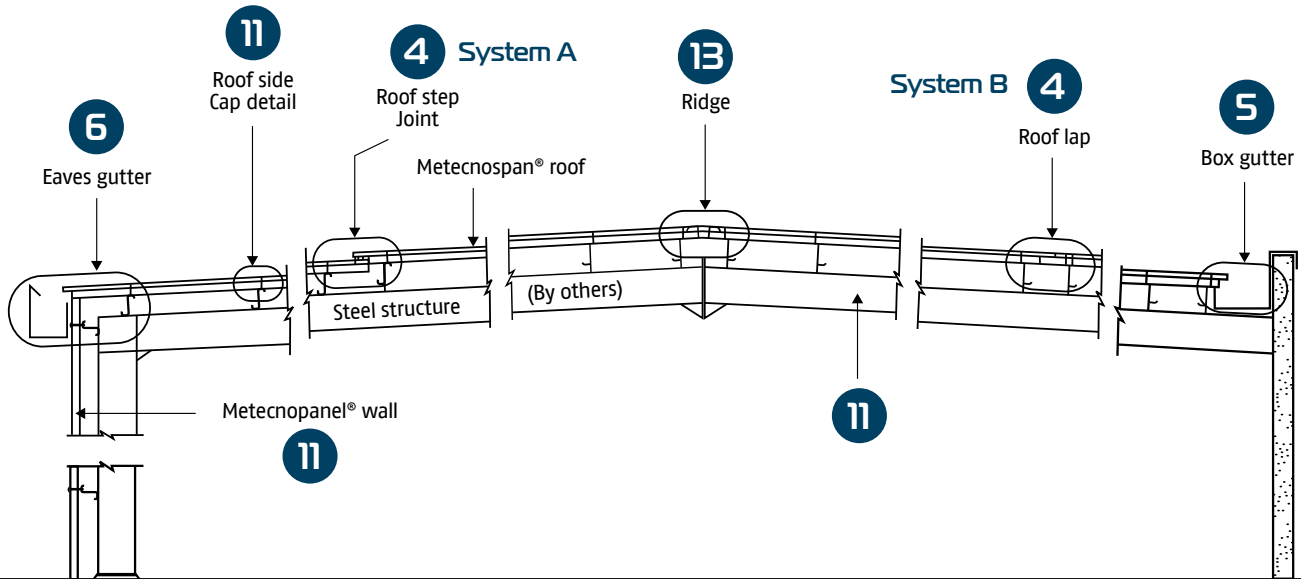

# MetecnoSpan® Standard Construction Drawings



## About Bondor®

Bondor® is Australia's leader in complete thermal building solutions and lightweight architectural panels. As a business, Bondor® has been at the forefront of the Australian panel industry for over 50 years. More importantly, Bondor® people individually have significant experience in manufacturing and installing panel to suit Australian conditions and to meet Australian building codes and regulations.

Being an Australian business is important to us and whilst we enthusiastically embrace lessons and new product developments from around the world we are proud that our experience is predominantly in Australia forged in Australian conditions for Australian building requirements. Bondor® people have grown and learned with the Australian building industry and will continue to do so. We have a depth of experienced staff across Australia.

## About this brochure

This brochure provides recommended construction drawings for MetecnoSpan® installations in Australia and New Zealand. The Australian Standards HB 39 Installation Code for Metal Roofing and Walling has been referenced.

The standard drawings detailed in this brochure are to be considered a guide and used in conjunction with all relevant Australian and New Zealand standards.

While this brochure provides details for all the common connections and penetrations, further project specific drawings may be required.

Where FM Approval is required, please consult our technical team for assistance as some details may vary.

MetecnoSpan® Profile Options	>	1
Expansion Step Detail	>	2
End Lap Detail	>	2
Un-insulated Box Gutter Detail	>	3
Insulated Box Gutter Detail	>	3
Eaves Gutter Detail 1	>	4
Eaves Gutter Detail 2	>	4
Skylight Panel Detail	>	5
Skylight Fastening Detail	>	5
Large Skylight Fitment Detail	>	6
Penetration Fitment Detail	>	6
Small Penetration Detail	>	7
Flexible Flashing Fitment	>	7
Insulated Penetration	>	8
Insulated Valley Box Gutter	>	8
Barge Capping Detail	>	9
Barge/Paraphet Detail	>	9
Non Cyclonic Fastening	>	10
Cyclonic Fastening	>	10
Ridge Detail Cyclonic	>	11
Ridge Detail (Non Cyclonic)	>	11
Head Flashing Detail	>	12
MetecnoSpan® Information Brochures	>	13

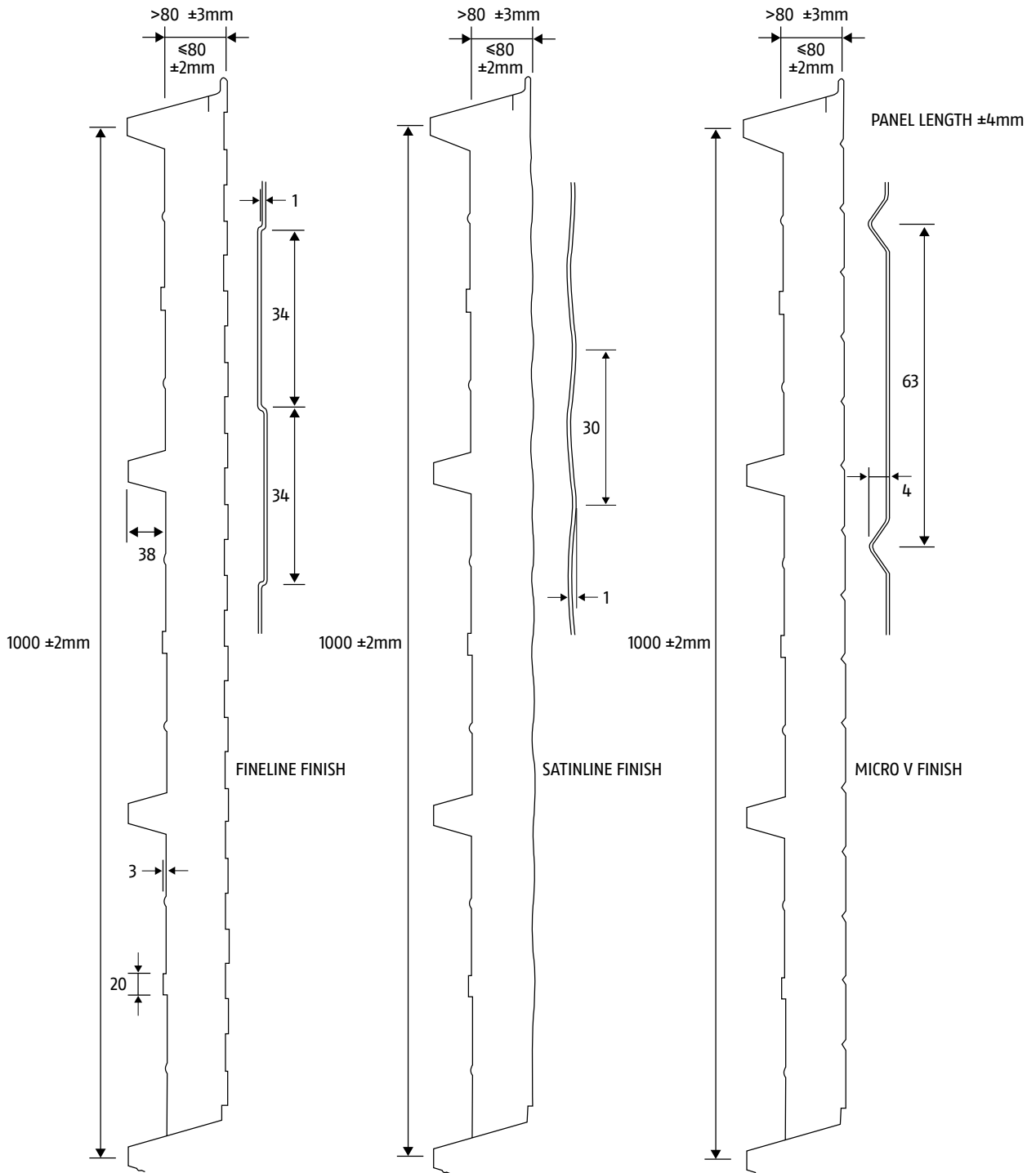

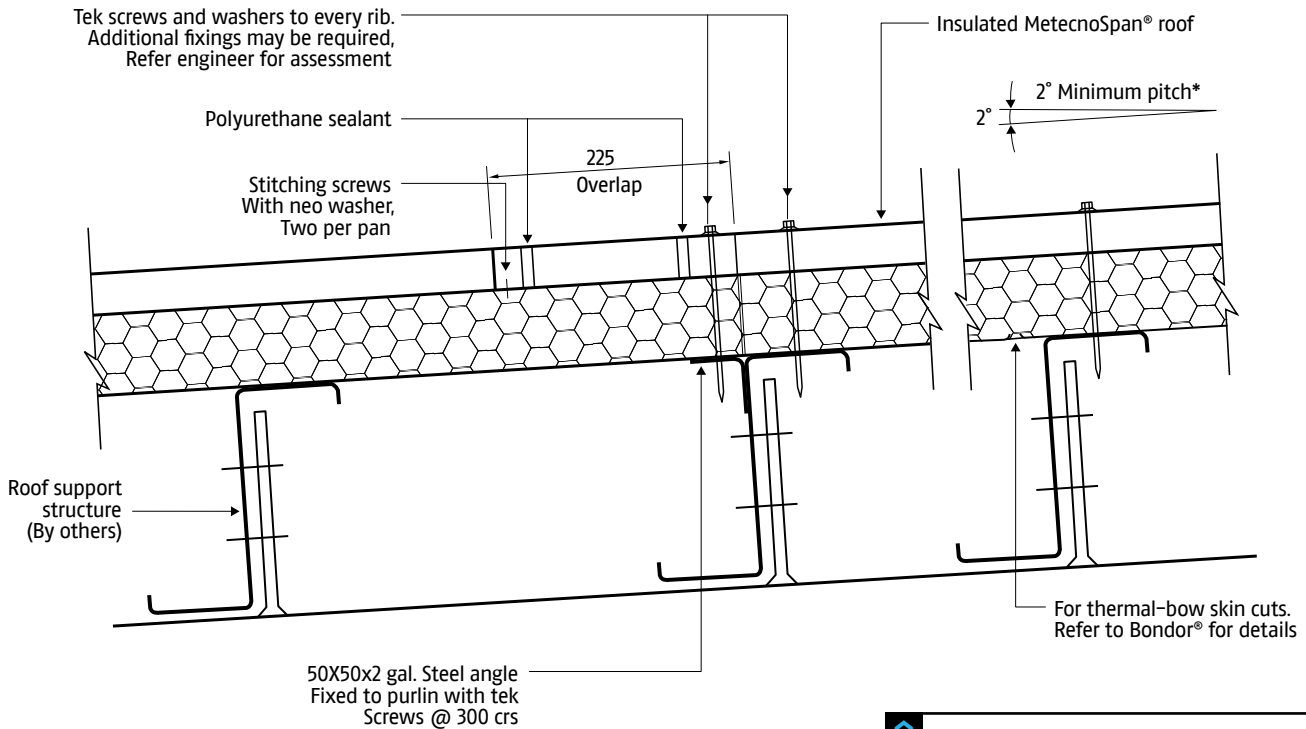
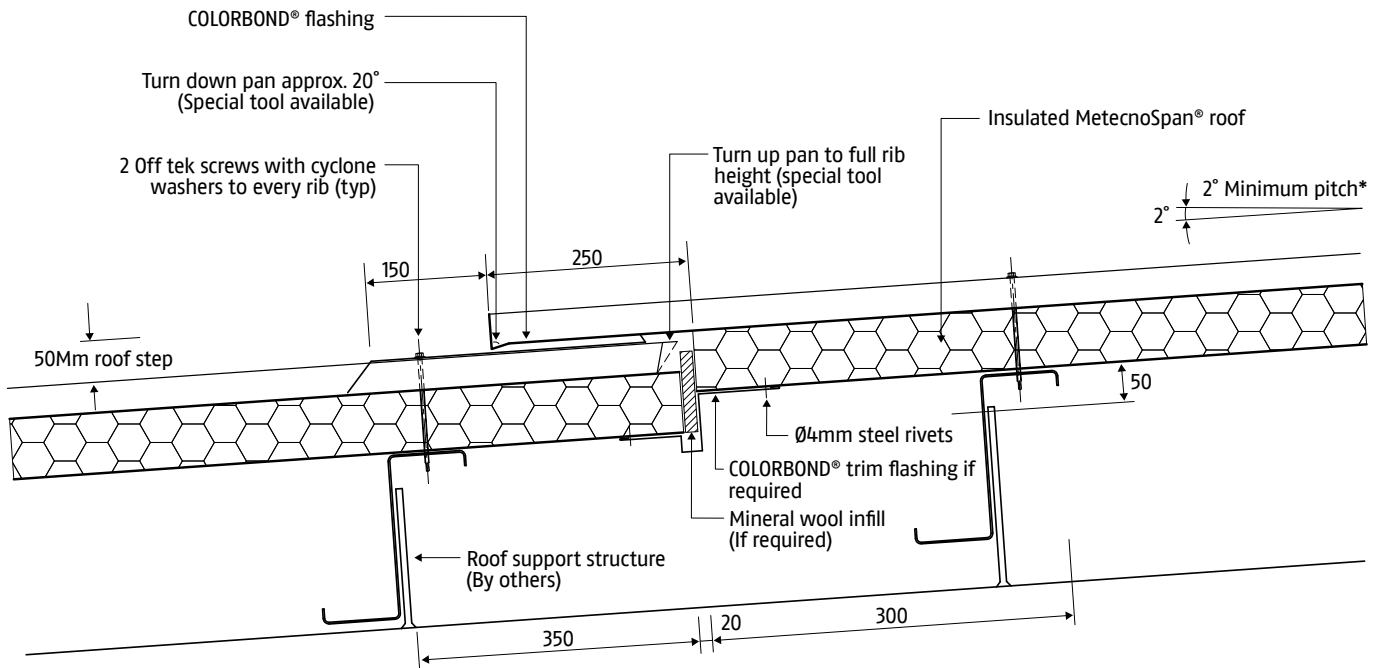

**NOTE >** For roof runs of MetecnoSpan® exceeding 16m, a stepped expansion joint is required. Refer to drawing No. PIR13-RJ01

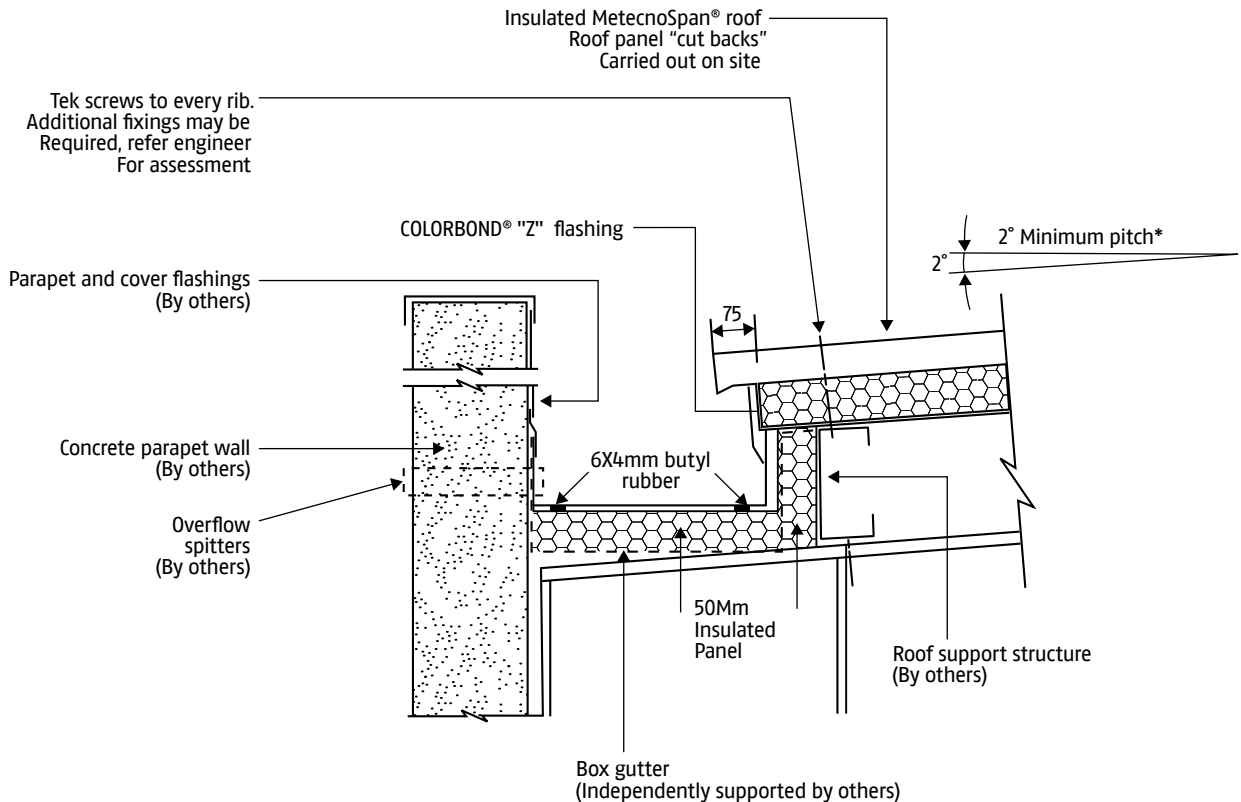
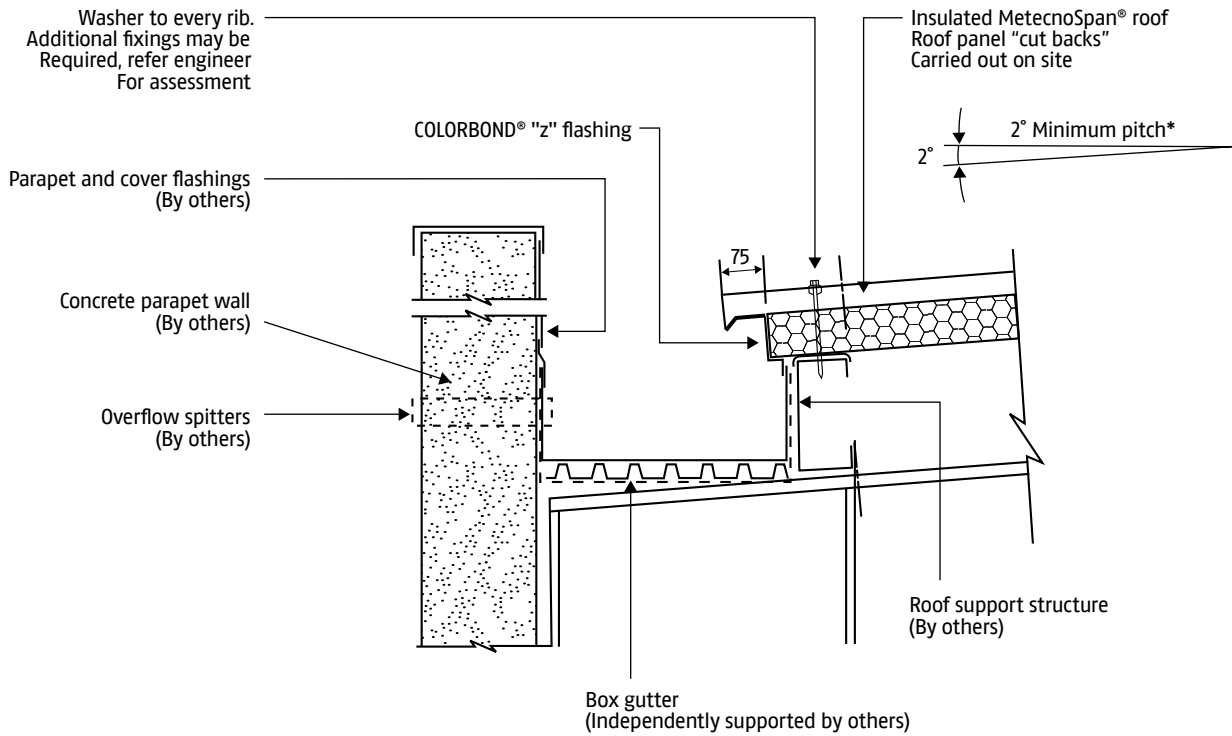

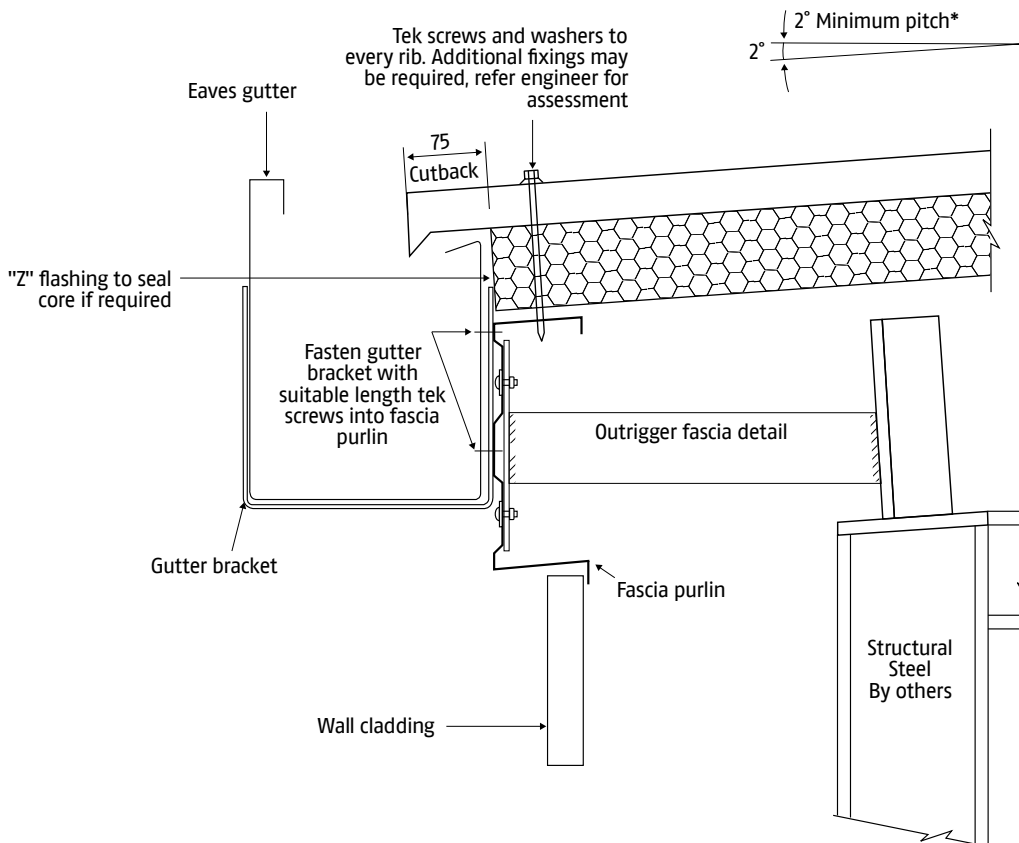
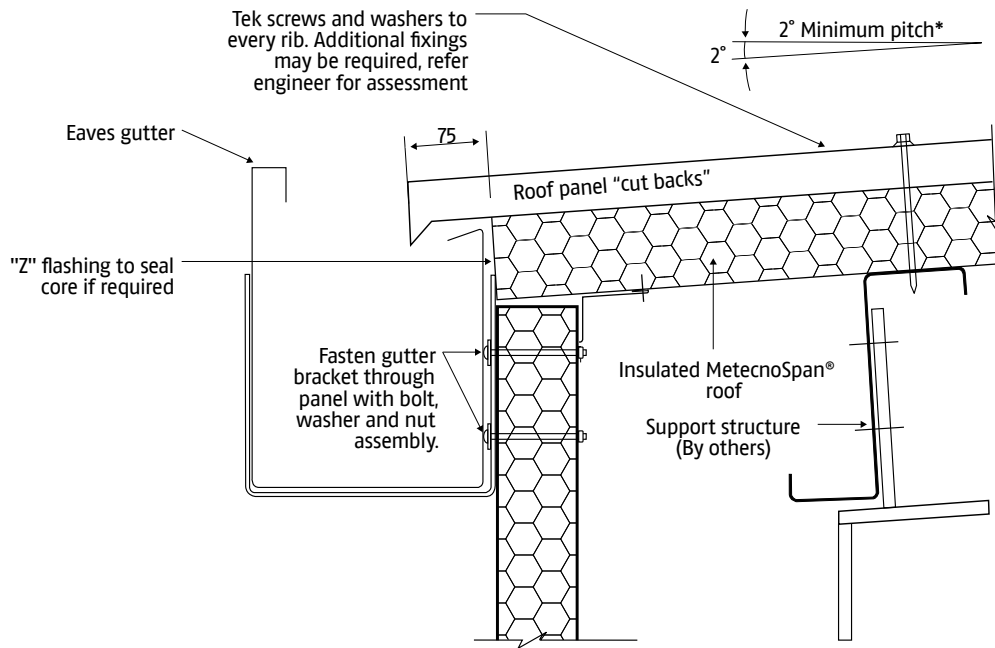

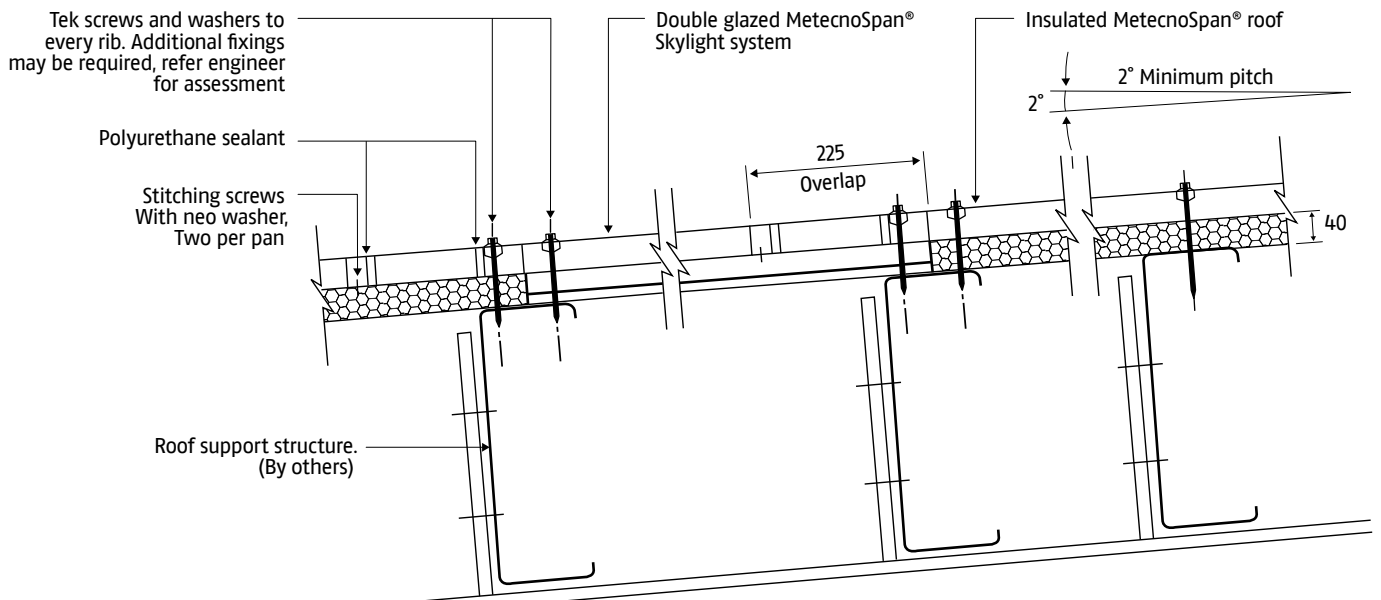
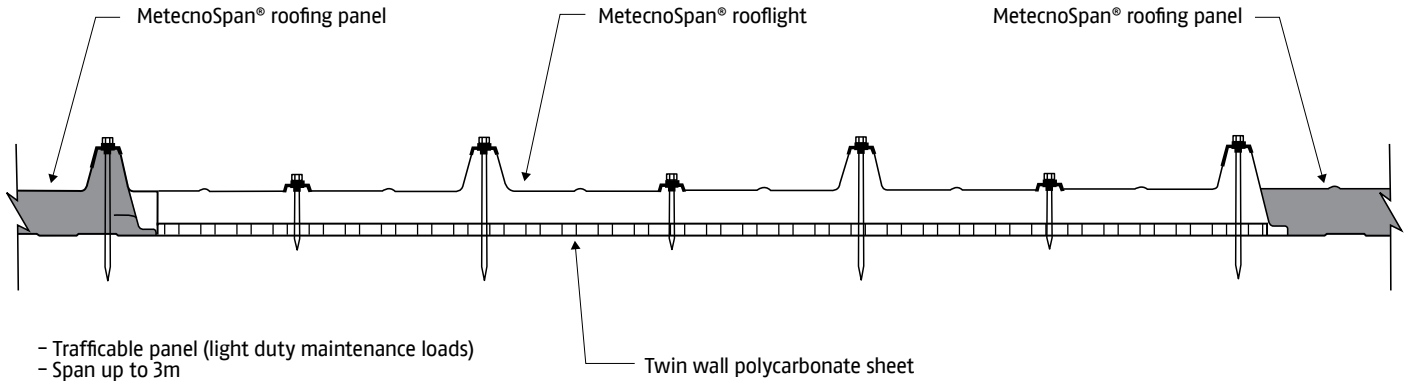

**NOTE >** For roof runs of MetecnoSpan® exceeding 16m, a stepped expansion joint is required. Refer to drawing No. PIR13-RJ01

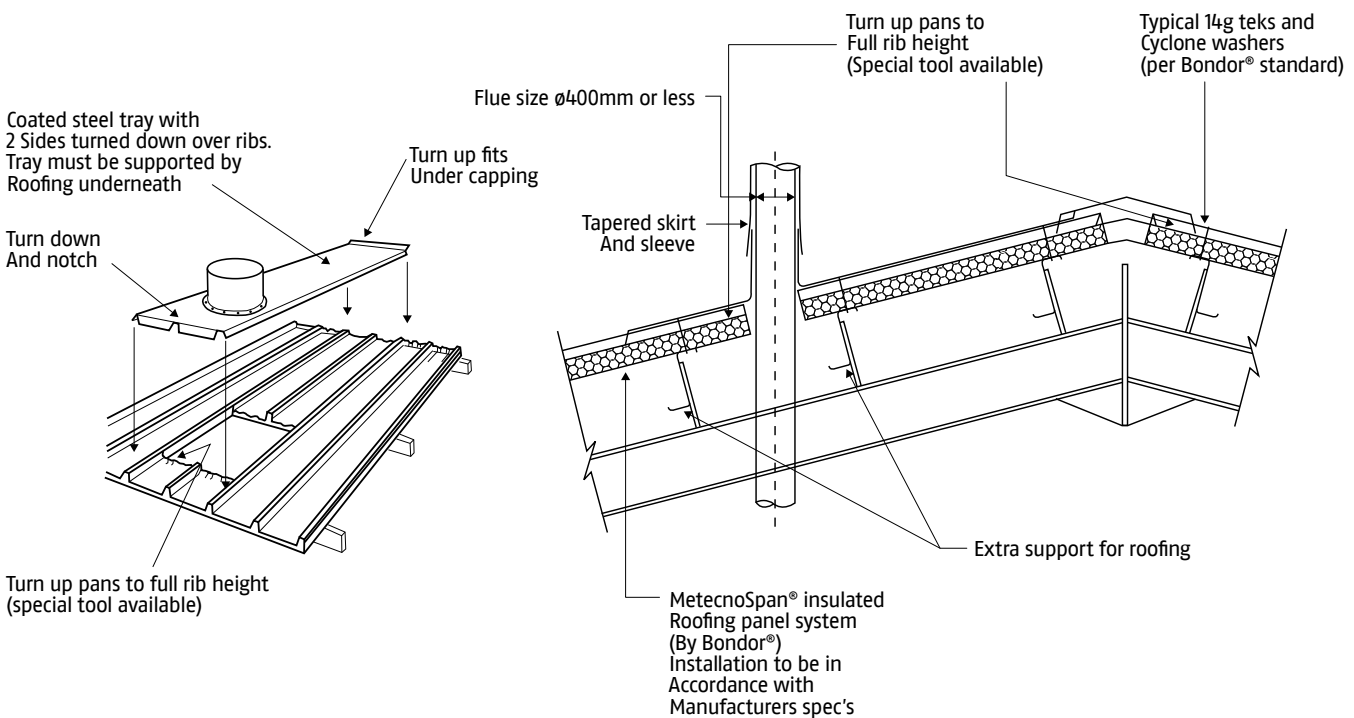
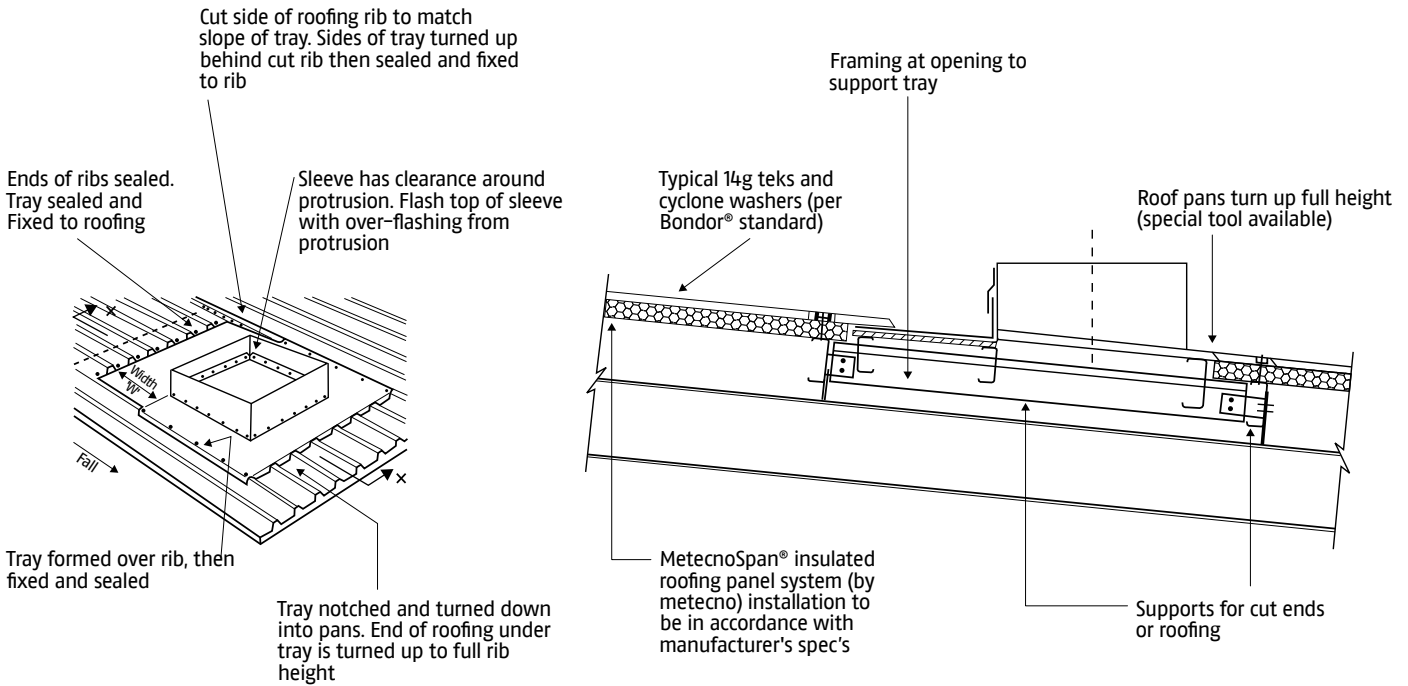



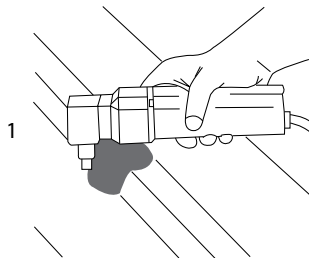
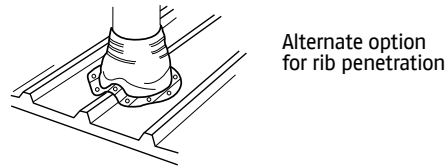
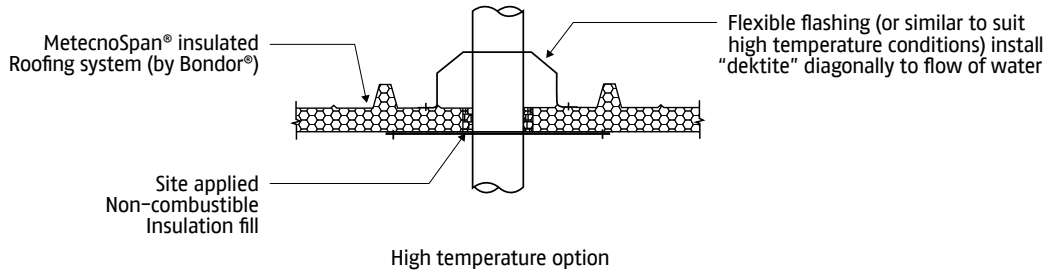
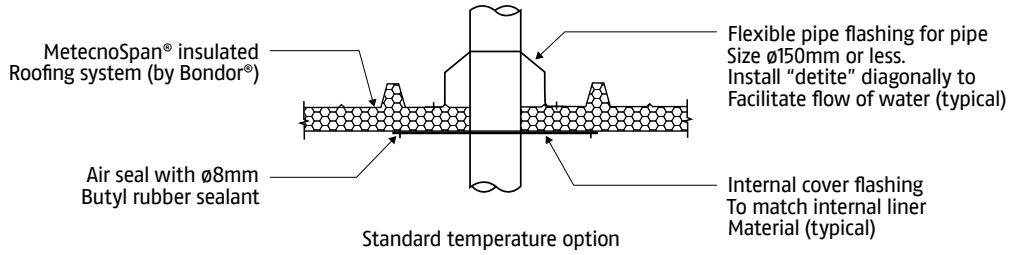

1  
Prearrange the hole for the pipe. Muffs must always be placed on top of the profiled sheet top in order to permit the water flow

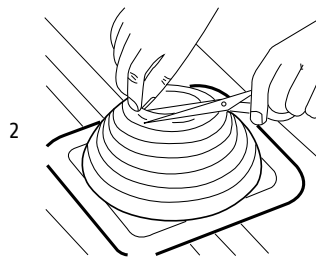

2  
Adapt the muff to the pipe. Cut the opening so as to be at least 25mm smaller than the pipe diameter in order to overlap the pipe at least 20mm

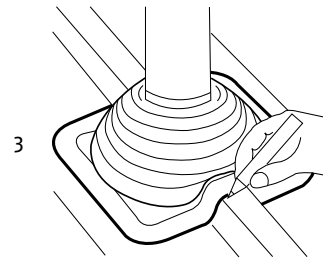

3  
Fold up the muff on the pipe, Eventually using white liquor (soap) adapt the muff to roof profile and Mark out the contour

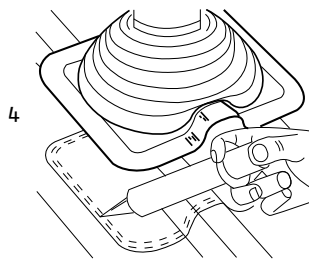

4  
Apply sealant along the trace

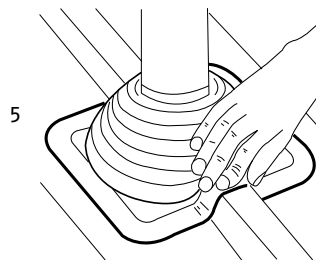

5  
Place the muff by pressing it to the roof surface

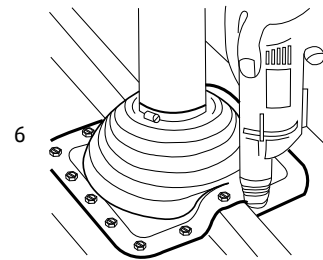

6  
Fasten the muff on to the MetecnoSpan® external profiled sheet (distance between screws equal to 50mm); then install the collar

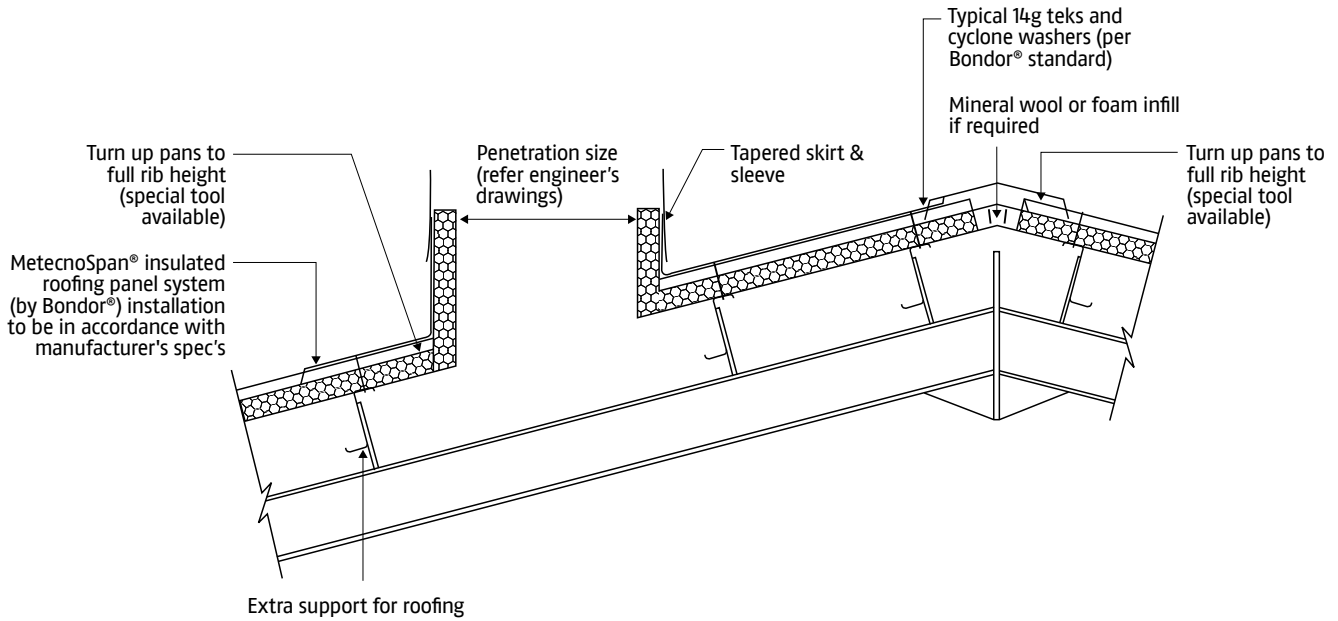

# Insulated valley box gutter

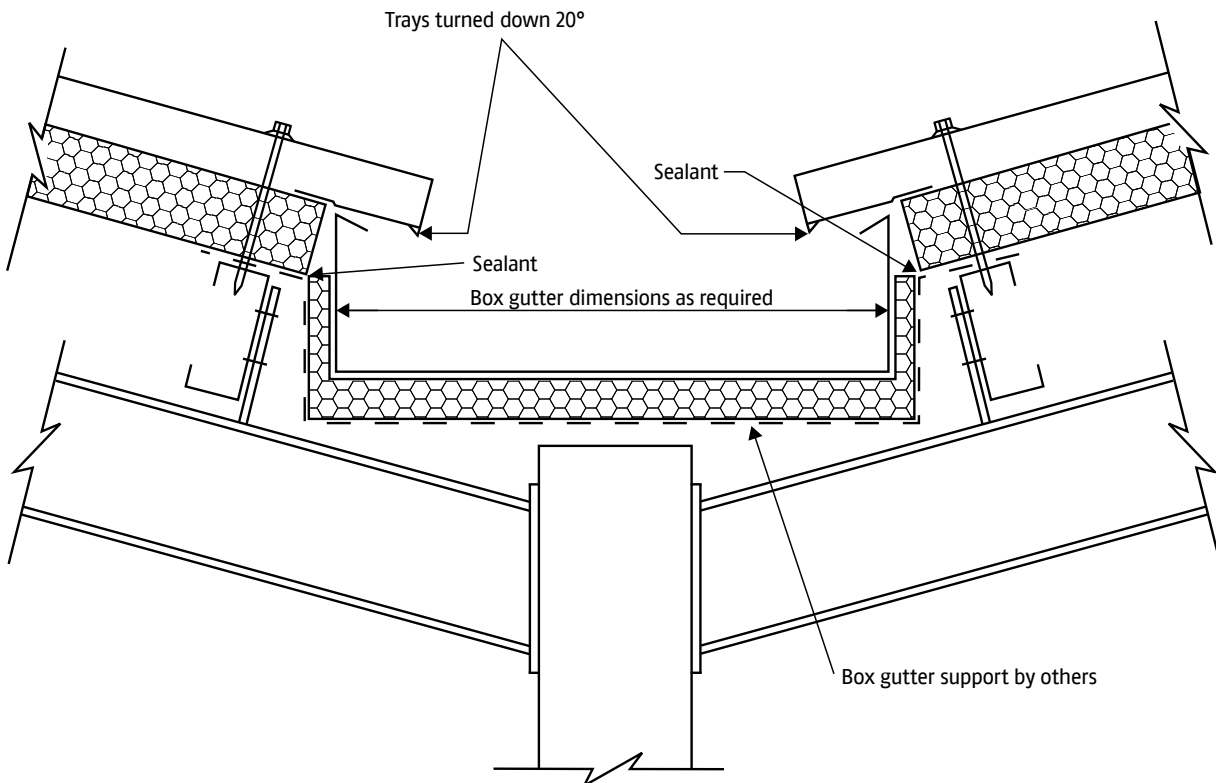

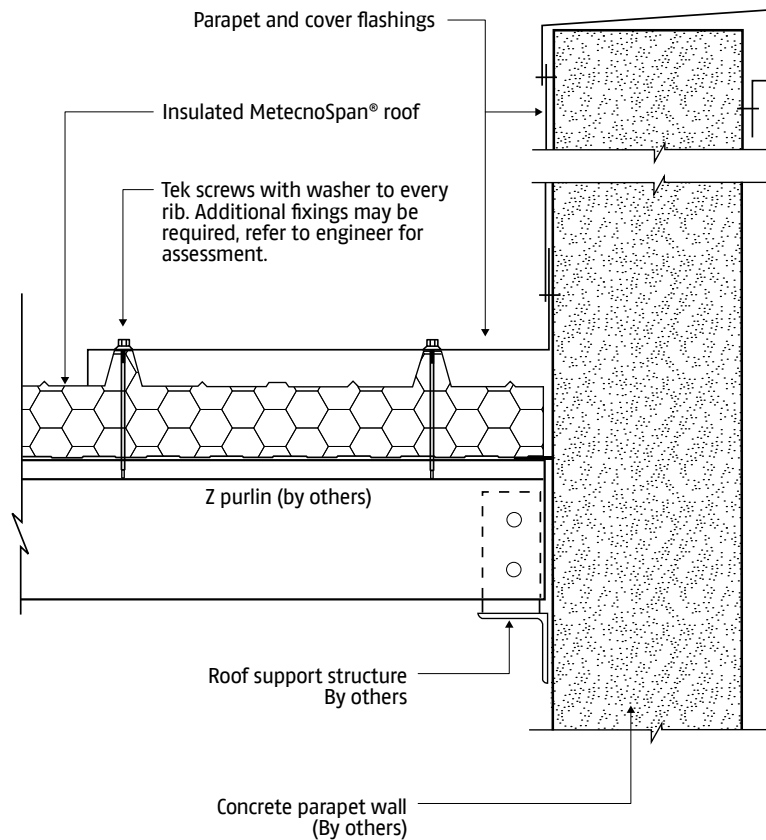
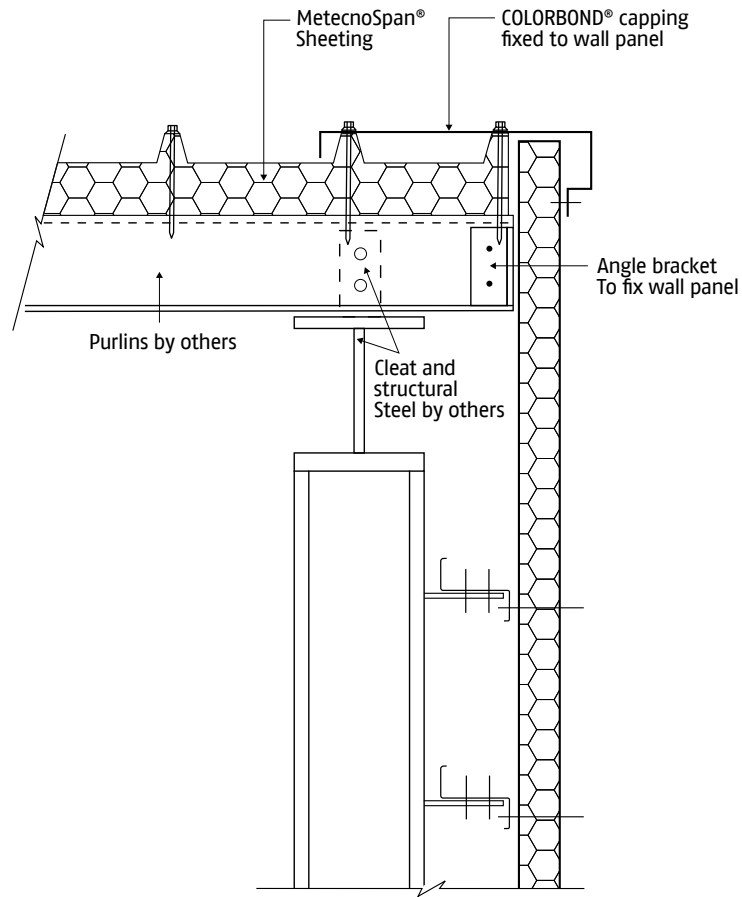

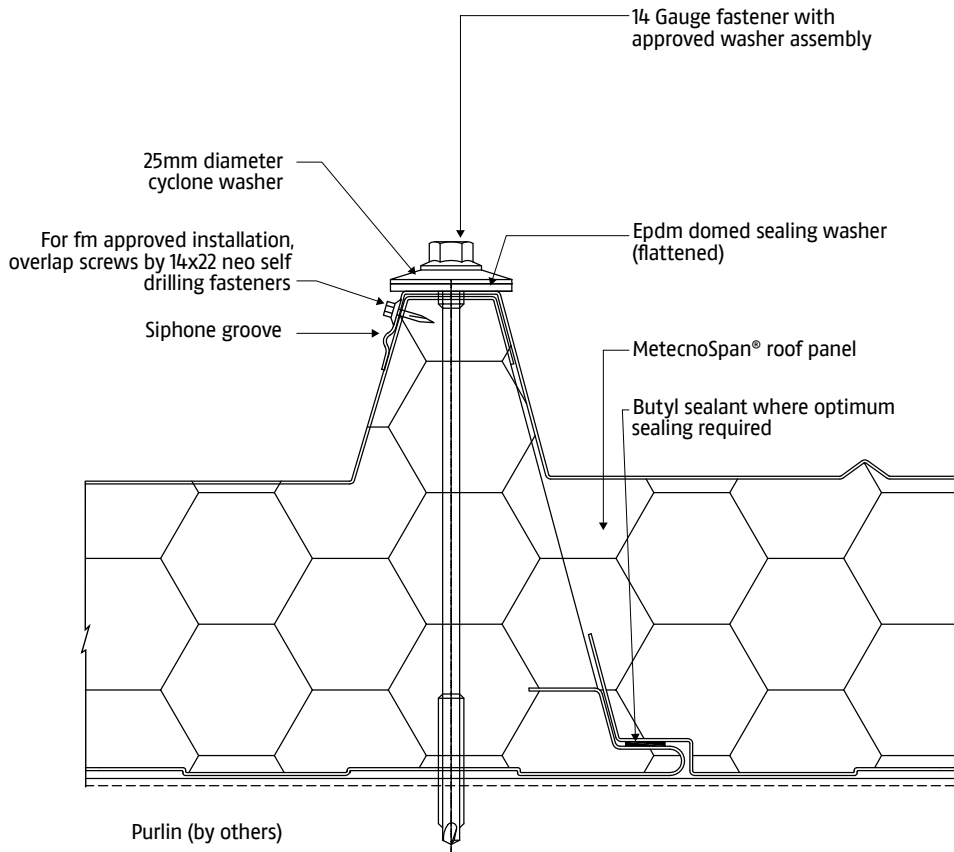
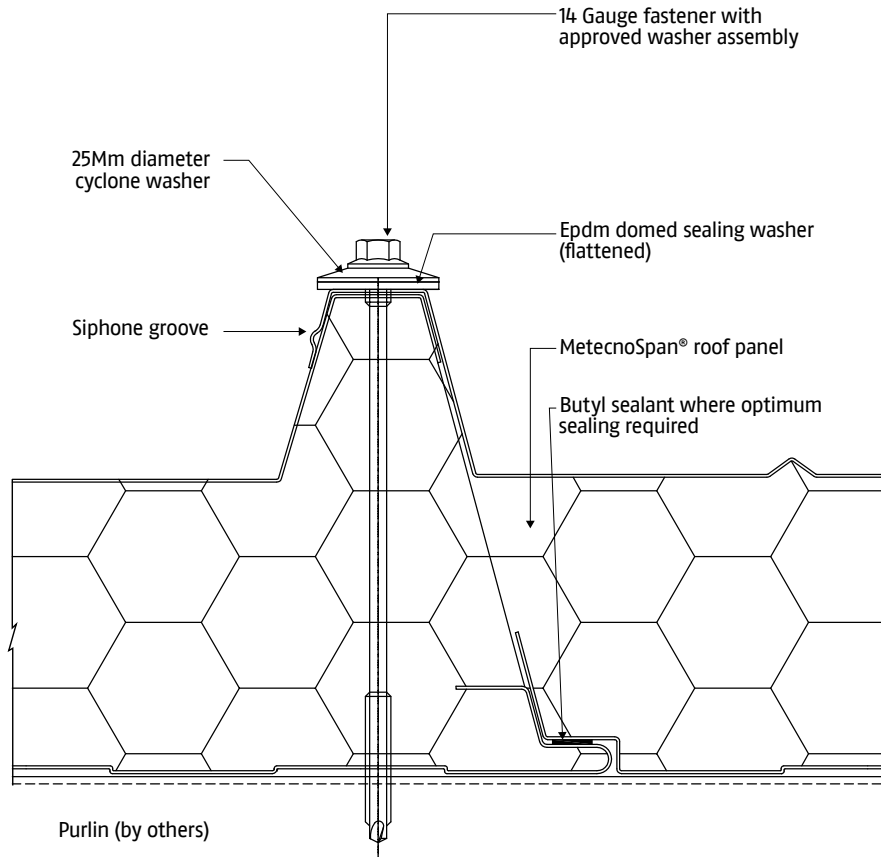

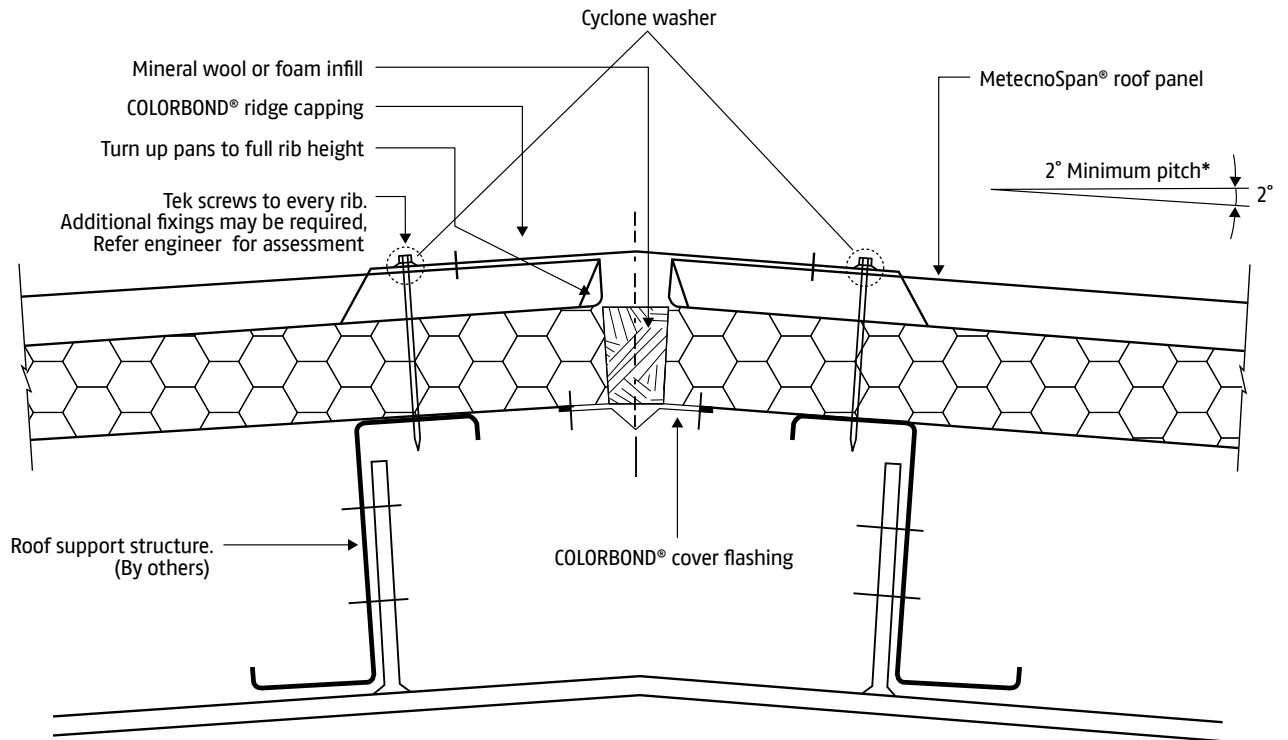
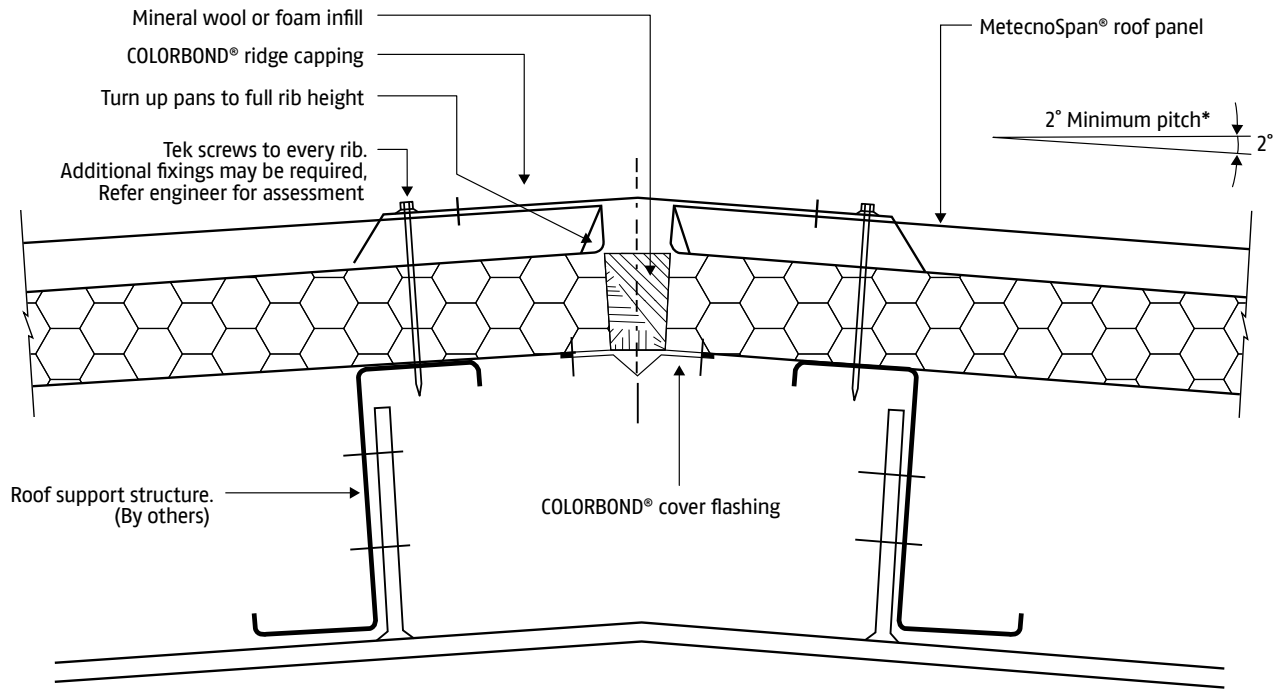

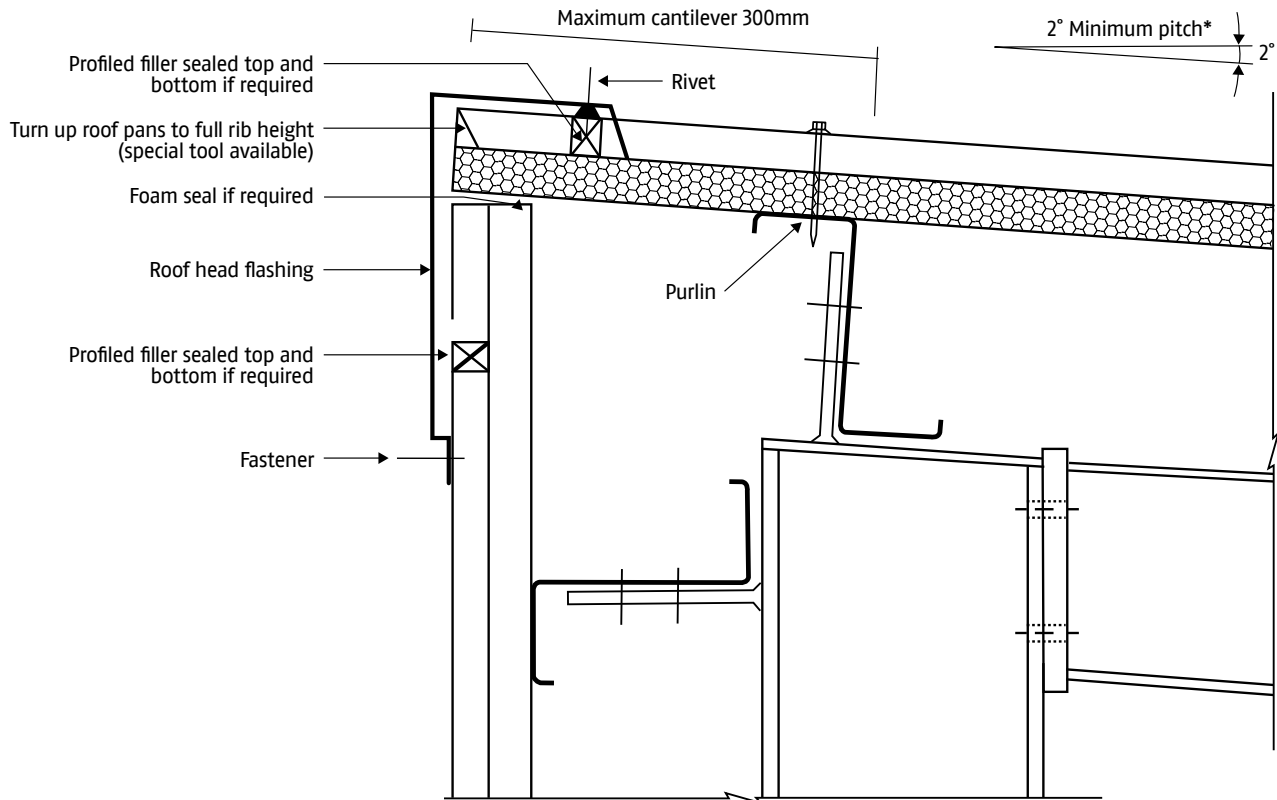

**PLEASE NOTE:**  
Design roof pitches can often suffer structural steel deflection. Our minimum pitch of 2° refers to actual pitch achieved after any deflection.



## Information Guide

The MetecnoSpan® Information Guide gives comprehensive information about the product, application and finishes, cost comparison and technical information relating to the construction process, materials and installation.

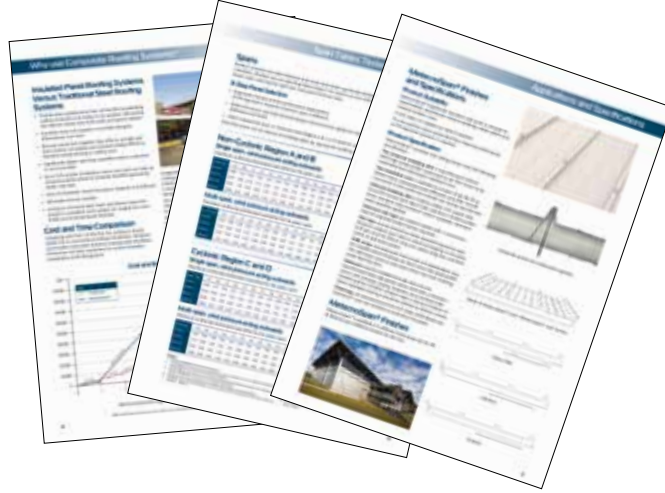

## Installation Guide

Our Installation Guide is supplied in a separate brochure and provides easy to follow, step by step sequence illustrations, common sense instructions and handy tips, particularly relevant to composite roofing installations.

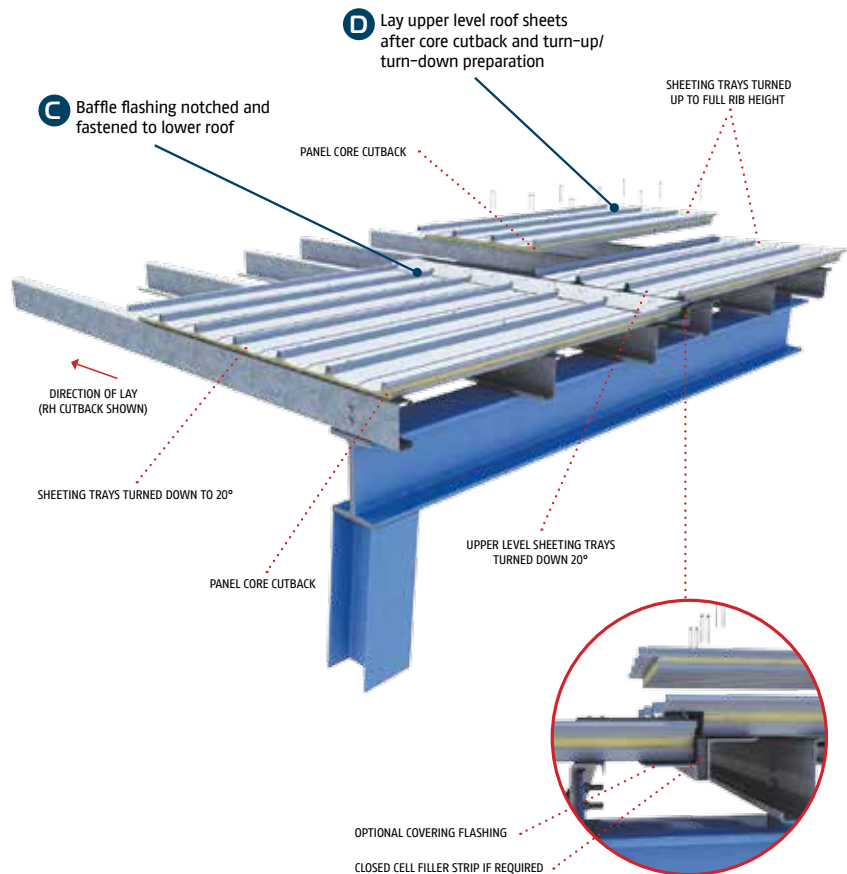

## Pocket Size Installation Guide

Our Pocket Size Installation Guide is available for use onsite.



Leaders in Thermal & Architectural Building Solutions

[www.bondor.com.au](http://www.bondor.com.au)

1300 300 099

**BRISBANE/EXPORT**

103 Ingram Road Acacia Ridge QLD 4110  
Ph: (07) 3323 8500 Fax: (07) 3323 8501

**ADELAIDE**

70-72 Rundle Road Salisbury South SA 5106  
Ph: (08) 8282 5000 Fax: (08) 8282 5099

**LAUNCESTON**

7 Connector Park Drive Kings Meadows TAS 7249  
Ph: (03) 6335 8500 Fax: (03) 6335 8544

**PERTH**

17 Gauge Circuit Canning Vale WA 6155  
Ph: (08) 9256 0600 Fax: (08) 9256 0620

**MELBOURNE**

329A St Albans Road Sunshine VIC 3020  
Ph: (03) 8326 8000 Fax: (03) 8326 8099

**SYDNEY**

49-53 Newton Road Wetherill Park NSW 2164  
Ph: (02) 9609 0888 Fax: (02) 9729 1114

Metecno Pty Limited. ABN 44 096 402 934. The manufacturer reserves the right to change the specification without notice.  
Bondor®, Equitilt®, BondorPanel®, FlameGuard®, MetecnoPanel®, InsulWall®, SolarSpan®, MetecnoSpan®, Purline®, Equideck®, InsulLiving®,  
Metecno, MetecnoSpanTH, MetecnoPanelTH & MetecnoInspire® are trademarks of Metecno Pty Limited.

BlueScope®, COLORBOND® and colour names are trademarks of BlueScope Steel.

The colours shown in this publication have been reproduced to represent actual product colours as accurately as possible.  
However, given printing limitations, we recommend checking your chosen colour against an actual sample before placing orders.

01/03/2016-BON0406